

For Commercial and Industrial Applications

Job Name _____

Contractor _____

Job Location _____

Approval _____

Engineer _____

Contractor's P.O. No. _____

Approval _____

Representative _____

Series B6002

2-Piece, Standard Port, Bronze Ball Valves

Sizes: 1/4" – 1" (8 – 25mm)

Series B6002 2-Piece, Standard Port, Bronze Ball Valves are special versions of the B6000 Series with male NPT threads at one end. These valves are specifically designed for use on manifold systems, OEM applications or other situations where it is desirable to install the ball valve directly to a female NPT connection.

Features

- Durafill® (carbon/glass filled PTFE) seats for sizes 1/4" – 1/2" (8-15mm); Uniseal® (enhanced PTFE) seats for sizes 3/4" & 1" (20 & 25mm) for longer lasting seats in high or low temperature applications
- Suitable for a full range of liquids and gases
- Chrome plated brass ball is wiped clean during each operation of the valve
- Minimal pressure drop due to large ports
- Blowout proof, pressure retaining stem
- Pressure rated at 600psi (41 bars) WOG non-shock; 150psi (10 bars) WSP
- NPT threaded female inlet x NPT threaded male outlet
- High cycle life reinforced PTFE stem packing seal and thrust washer
- Vinyl insulator on heavy duty, zinc-plated, carbon steel handle
- Quarter-turn open or close operation
- Low operating torque
- Adjustable stem packing gland
- Each valve factory tested

Specifications

A 2-piece standard port bronze ball valve to be installed as indicated on the plans. The valve must have a blowout proof pressure retaining stem, Durafill® seats (1/4" – 1/2") or Uniseal® seats (3/4" & 1"), reinforced PTFE stem packing seal, adjustable packing and chrome plated brass ball. Pressure rating no less than 600psi (41 bars) WOG non-shock and 150psi (10 bars) WSP. Valve shall have female NPT x male NPT end connections and conform to MSS-SP-110. Valve shall be a Watts Regulator Company Series B6002.

Durafill® is a registered trademark of Cargill, Limited.

Uniseal® is a registered trademark of Uniseal, Incorporated.

Teflon® is a registered trademark of the E.I. Dupont de Nemours & Company, Incorporated.



B6002

Options

Suffix

- BS – Balancing stop
- CC – 3/4" (19mm) hose thread outlet. Hose thread outlet has cap & chain. Inlet sizes: 1/2" and 3/4" (13 and 19mm) NPT. Also 1/2" and 3/4" (13 and 19mm) solder inlet connection
- GS – Ground Washer
- LH – Locking lever handle
- OV – Oval handle
- OVLH – Oval locking handle
- RH – Round handle
- SH – Stainless steel handle and nut
- SS – 316 stainless steel ball and stem
- TH – Tee handles 1/4" – 2" (6 – 51mm)
- VT – Virgin Teflon® seat material
- XH – Extended handle
- Z15 – Less lever and nut
- 04 – Mineral filled PTFE seats and seals (available only with 316SS ball and stem)

Pressure — Temperature

Temperature Range: -20°F – 450°F (-29°C – 232°C) @ 50psi (3.4 bars)

Maximum Working Pressure: 600psi (41 bars) WOG non-shock;
150psi (10 bars) WSP



Watts product specifications in U.S. customary units and metric are approximate and are provided for reference only. For precise measurements, please contact Watts Technical Service. Watts reserves the right to change or modify product design, construction, specifications, or materials without prior notice and without incurring any obligation to make such changes and modifications on Watts products previously or subsequently sold.

Materials

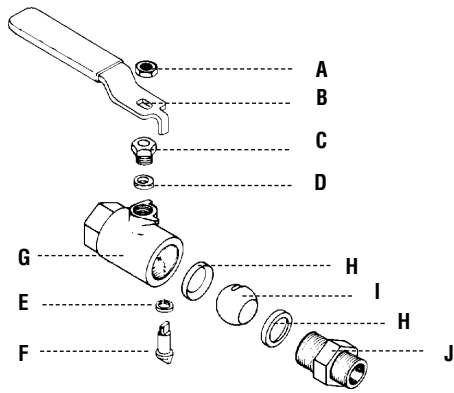

- A Handle Nut** Zinc Plated Carbon Steel
- B Handle** Zinc Plated Carbon Steel with Vinyl Insulator
- C Packing Nut** Brass ASTM B16, C36000
- D Stem Packing** Glass Reinforced PTFE
- E Thrust Washer** Glass Reinforced PTFE
- F Stem** Brass ASTM B16, C36000
- G Body** Cast Bronze ASTM B584, C84400
- H Seats** Durafill® (¼" - ½")
Uniseal® (¾" - 1")
- I Ball** Chrome Plated Brass ASTM B16, C36000
- J Adapter** Brass ASTM B16, C36000

Valve Seat Rating

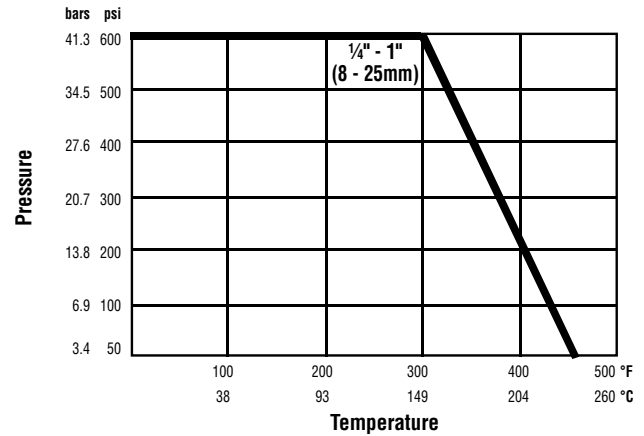

SIZE (DN)		RATING
in.	mm	Cv
¼, ⅜	8, 10	6.3
½	15	15
¾	20	25
1	25	40

Pressure Drop vs. Flow

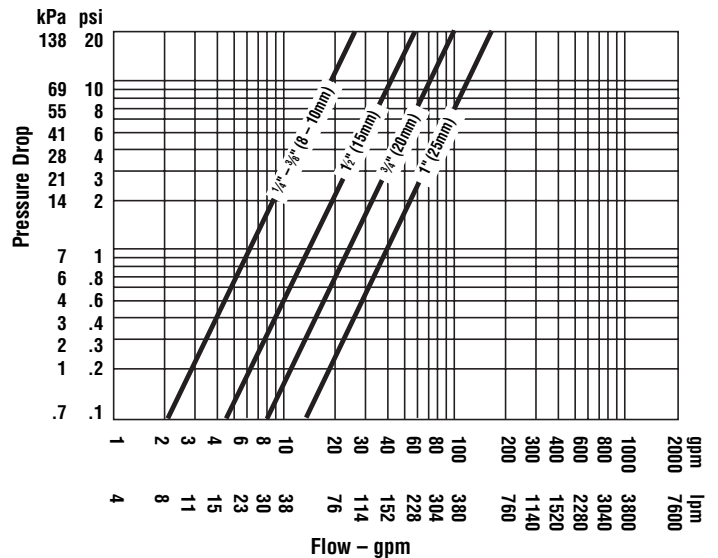

Dimensions — Weights

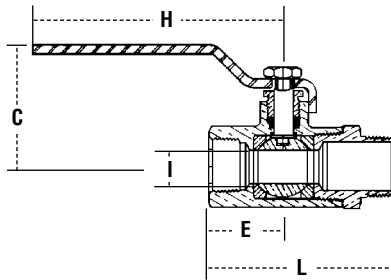

SIZE (DN)		DIMENSIONS								WEIGHT				
in.	mm	C		E		H		I		L		lbs.	kg.	
		Center to Handle	in.	mm	Center to End	in.	mm	Radius of Handle	in.	mm	Ball Orifice			in.
¼	8	1¾	45	1¼	27	3¼	78	⅜	10	2½	64	.58	.26	
⅜	10	1¾	45	1¼	27	3¼	78	⅜	10	2½	64	.60	.27	
½	15	1¾	45	1¼	27	3¼	97	½	13	2⅞	73	.63	.28	
¾	20	2¼	52	1⅞	37	3¼	97	11/16	17	3¼	87	1.19	.54	
1	25	2⅞	60	1¼	43	4¼	116	7/8	22	4⅞	105	2.13	.96	



USA: 815 Chestnut St., No. Andover, MA 01845-6098; www.wattsreg.com
Canada: 5435 North Service Rd., Burlington, ONT. L7L 5H7; www.wattscanada.ca