

For Residential and Commercial Applications

Job Name _____

Contractor _____

Job Location _____

Approval _____

Engineer _____

Contractor's P.O. No. _____

Approval _____

Representative _____

LEAD FREE*

**Series 35
Quick-Connect
Manifolds**

Watts Quick-Connect Manifolds are designed and manufactured for many years of trouble free service. Produced of off white Polysulfone, a high performance thermal plastic material, the Watts Quick-Connect design allows for quick and easy connections without the use of installation tools.

Specifications

Connection shall be made using Watts Series 35 Quick-Connect fitting with Integral Collet and O-Ring guide. Fitting shall be able to fully rotate under pressure and allow for easy disconnect and re-use without the use of disconnection tools. Fitting must not disassemble to disconnect.

Approvals

NSF-61, NSF-14, CSA B137.5, ASTM F877, UPC, ASSE 1061

Ratings

100psi @ 180°F (6.8 bar @ 82°C)
250psi @ 75°F (17.3 bar @ 24°C)

Example

3589-1810
35 = Series 35 89 = Type 89 Single Union Body
1810 = 1"CTS x 1/2"CTS

***The wetted surface of this product contacted by consumable water contains less than one quarter of one percent (0.25%) of lead by weight.**

Caution: The polysulfone material used in the Quick-Connect fittings can be compromised by exposure to volatile organic compounds (VOC's) and caustic chemicals. Therefore, **DO NOT** expose this product to any such chemical or foreign substance, which would include exposure to the following products: **Pipe Dopes (thread sealants)**, bug sprays, lubricants, cleaners, paints, bleaches, acids, solder fluxes, plastic piping primers and cements, oxidizing agents, alkaline solutions, thinners, fuels, oil based caulks, hydrocarbons, spray foam or foaming agents (insulation).

It is also recommended that all threaded connections be made with Teflon® tape only.

Watts product specifications in U.S. customary units and metric are approximate and are provided for reference only. For precise measurements, please contact Watts Technical Service. Watts reserves the right to change or modify product design, construction, specifications, or materials without prior notice and without incurring any obligation to make such changes and modifications on Watts products previously or subsequently sold.



Assembly Elements

35 Series Quick-Connect Manifold

Single Side Style

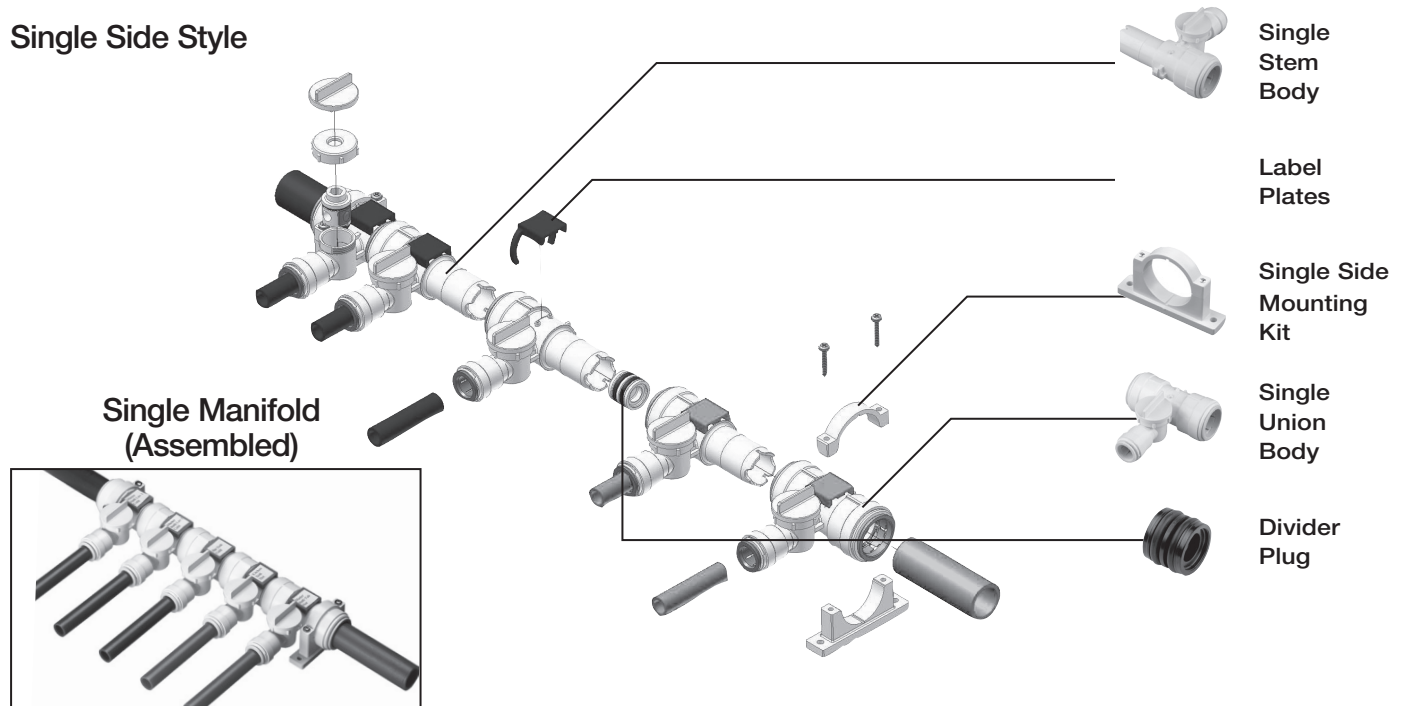

Dual Side Style

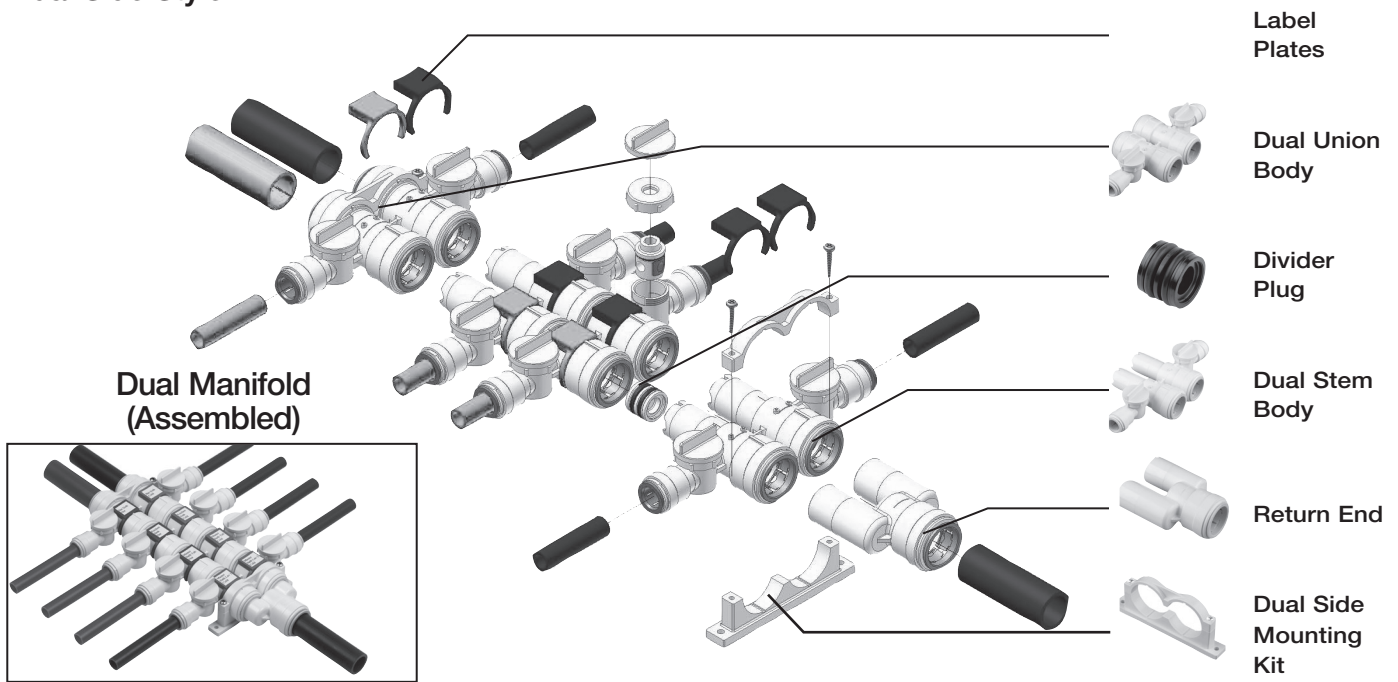

Installation Dimensions

35 Series Quick-Connect Manifold

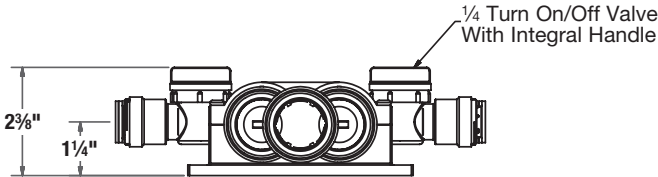
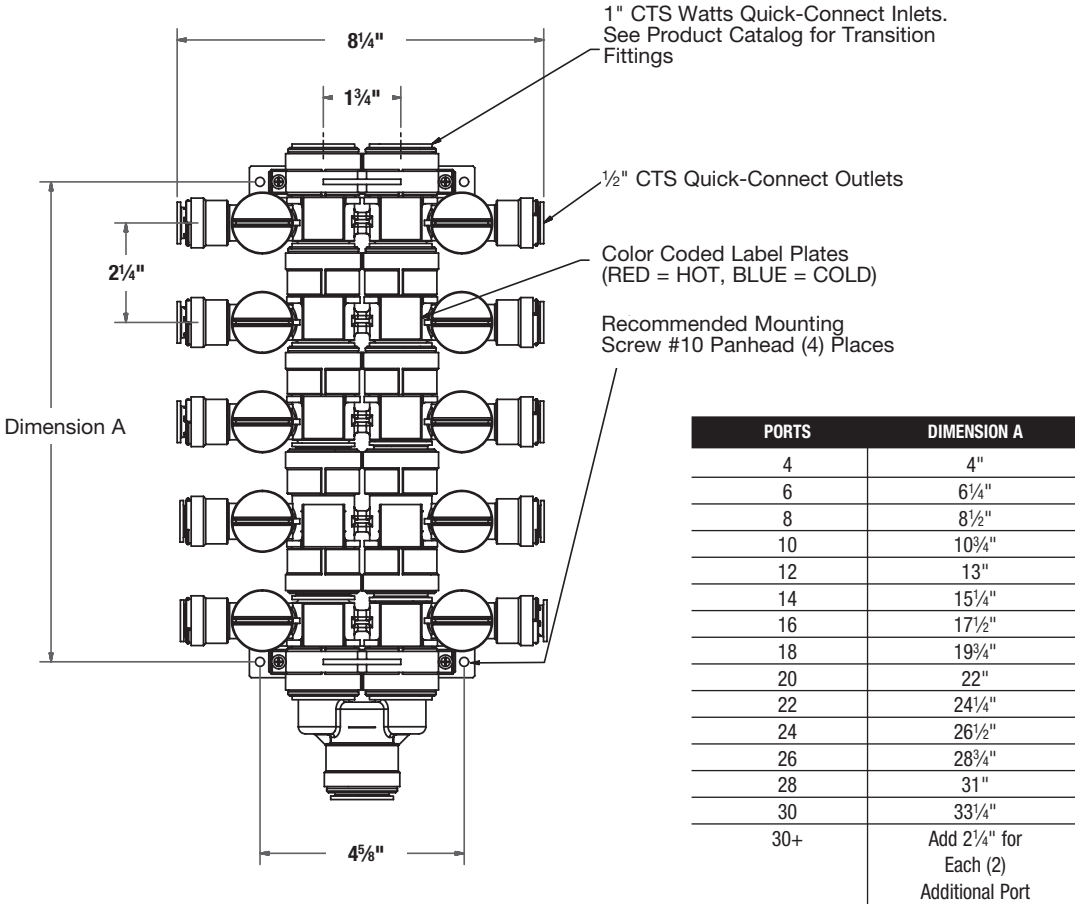

Weights – Weights are approximate

Manifolds - Single

Type 89 Manifolds - Single Union Body

MODEL	SIZE & CONNECTION	ITEM WEIGHT	
		lbs.	kg.
Package Type: Bulk			
3589-1810	1" CTS x 1/2" CTS	3.4	1.5
Package Type: Poly Bag			
3589B-1810	1" CTS x 1/2" CTS	3.4	1.5

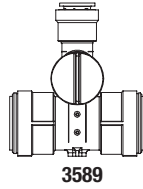

Type 90 Manifolds - Single Stem Body - Right

MODEL	SIZE & CONNECTION	ITEM WEIGHT	
		lbs.	kg.
Package Type: Bulk			
3590-1810	1" CTS x 1/2" CTS	3	1.4
Package Type: Poly Bag			
3590B-1810	1" CTS x 1/2" CTS	3	1.4

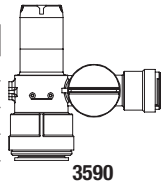

Type 91 Manifolds - Single Stem Body - Left

MODEL	SIZE & CONNECTION	ITEM WEIGHT	
		lbs.	kg.
Package Type: Bulk			
3591-1810	1" CTS x 1/2" CTS	3	1.4
Package Type: Poly Bag			
3591B-1810	1" CTS x 1/2" CTS	3	1.4

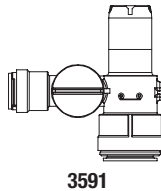

Type 81 - Manifold Single Side Mounting Kits

MODEL	SIZE & CONNECTION	ITEM WEIGHT	
		lbs.	kg.
Package Type: Bulk			
3581-18	For 35 Series	1.1	.5
Package Type: Poly Bag			
3581B-18	For 35 Series	1.1	.5

3581

Manifolds - Dual

Type 83 Manifolds - Dual Union Body

MODEL	SIZE & CONNECTION	ITEM WEIGHT	
		lbs.	kg.
Package Type: Bulk			
3583-1810	1" CTS x 1/2" CTS	6.8	3.1
Package Type: Poly Bag			
3583B-1810	1" CTS x 1/2" CTS	6.8	3.1

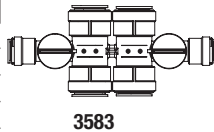

Type 84 Manifolds - Dual Stem Body

MODEL	SIZE & CONNECTION	ITEM WEIGHT	
		lbs.	kg.
Package Type: Bulk			
3584-1810	1" CTS x 1/2" CTS	6	2.7
Package Type: Poly Bag			
3584B-1810	1" CTS x 1/2" CTS	6	2.7

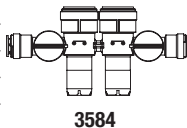

Manifolds - Dual (cont'd)

Type 80 Manifold Dual Side Mounting Kits

MODEL	SIZE & CONNECTION	ITEM WEIGHT	
		lbs.	kg.
Package Type: Bulk			
3580-18	For 35 Series	1.5	.69
Package Type: Poly Bag			
3580B-18	For 35 Series	1.5	.69

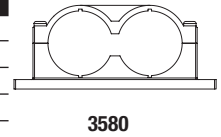

Type 82 Manifold Divider Plugs

MODEL	SIZE & CONNECTION	ITEM WEIGHT	
		lbs.	kg.
Package Type: Bulk			
3582-18	For 35 Series	0.3	.14
Package Type: Poly Bag			
3582B-18	For 35 Series	0.3	.14



Type 85 Manifold Return Ends

MODEL	SIZE & CONNECTION	ITEM WEIGHT	
		lbs.	kg.
Package Type: Bulk			
3585-18	1" CTS	2.3	1.0
Package Type: Poly Bag			
3585B-18	1" CTS	2.3	1.0

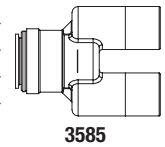

Type 86 Manifold Label Plates

MODEL	SIZE & CONNECTION	ITEM WEIGHT	
		lbs.	kg.
Package Type: Bulk			
3586-Red	Red - For 35 and Metric	0.2	.09
Package Type: Poly Bag			
3586B-Red	Red - For 35 and Metric	0.2	.09

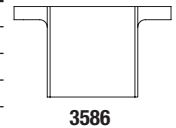

Type 87 Manifold Label Plates

MODEL	SIZE & CONNECTION	ITEM WEIGHT	
		lbs.	kg.
Package Type: Bulk			
3587-Blue	Blue - For 35 and Metric	0.2	.09
Package Type: Poly Bag			
3587B-Blue	Blue - For 35 and Metric	0.2	.09

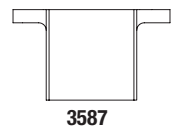

Type 88 Manifold Valve Repair Kits

MODEL	SIZE & CONNECTION	ITEM WEIGHT	
		lbs.	kg.
4Package Type: Bulk			
3588-10	1/2" Spool	0.7	.32
Package Type: Poly Bag			
3588B-10	1/2" Spool	0.7	.32

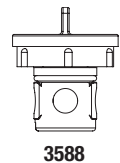

Type 80-MT Manifold Tool

MODEL	SIZE & CONNECTION	ITEM WEIGHT	
		lbs.	kg.
4Package Type: Poly Bag			
3580-MT	Easy Removal of Outlets	.12	.05

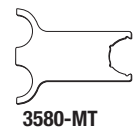

WATTS®

A Watts Water Technologies Company



**ISO 9001-2000
CERTIFIED**

USA: 815 Chestnut St., No. Andover, MA 01845-6098; www.watts.com

Canada: 5435 North Service Rd., Burlington, ONT. L7L 5H7; www.wattscanada.ca