

For Non-Health Hazard Applications

Job Name _____
 Job Location _____
 Engineer _____
 Approval _____

Contractor _____
 Approval _____
 Contractor's P.O. No. _____
 Representative _____

LEAD FREE*
Series e480 HydroGuard®
Lavatory Tempering Valve

Features

- Adjustable temperature selection with locknut to prevent tampering
- Advanced thermal actuator improves performance
- Temperature controls to ASSE 1070, down to 0.5 gpm
- Solid brass construction enhances durability
- Corrosion resistant internal components for extended life
- Integral checks with screens prevents cross flow and filter out debris
- Factory set to 105°F (41°C)

Specifications

Connections See ordering code
 Maximum Operating Pressure 125 psi (861 kPa)
 Maximum Hot Water Temperature 180°F (82°C)
 Minimum Hot Water Supply Temperature 5°F (3°C) Above Set Point*
 Hot Water Inlet Temperature Range 120 – 180°F (49 – 82°C)
 Cold Water Inlet Temperature Range 40 – 80°F (4 – 27°C)
 Temperature Adjustment Range 80 – 120°F (27 – 49°C)
 Minimum Flow 0.5 gpm (1.9 lpm)
 Listing ASSE 1070
 Approval CSA B125.3 Certified

* With Equal Pressure

Flow Capacity

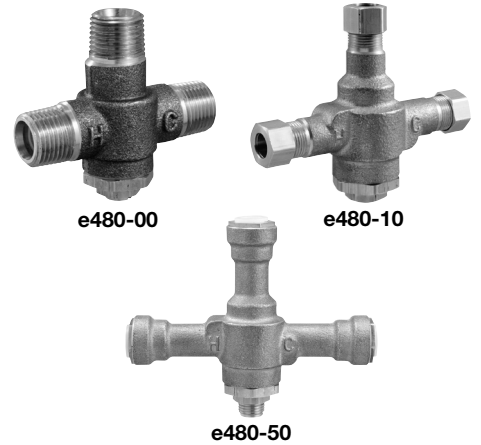
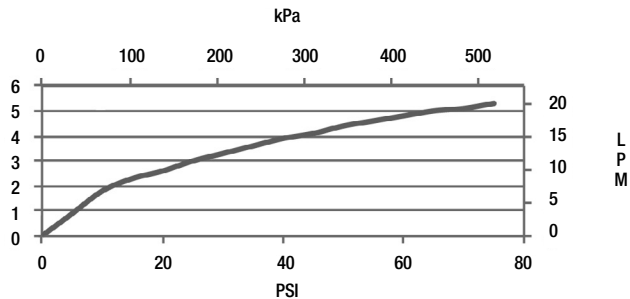

Powers product specifications in U.S. customary units and metric are approximate and are provided for reference only. For precise measurements, please contact Powers Technical Service. Powers reserves the right to change or modify product design, construction, specifications, or materials without prior notice and without incurring any obligation to make such changes and modifications on Powers products previously or subsequently sold.

Dimensions

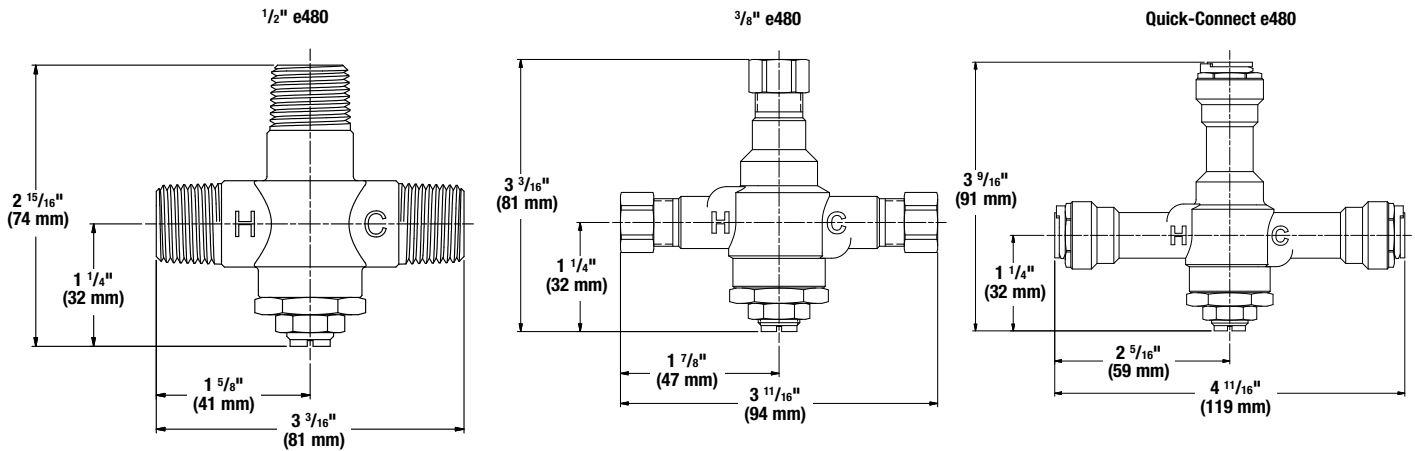

Piping Diagram

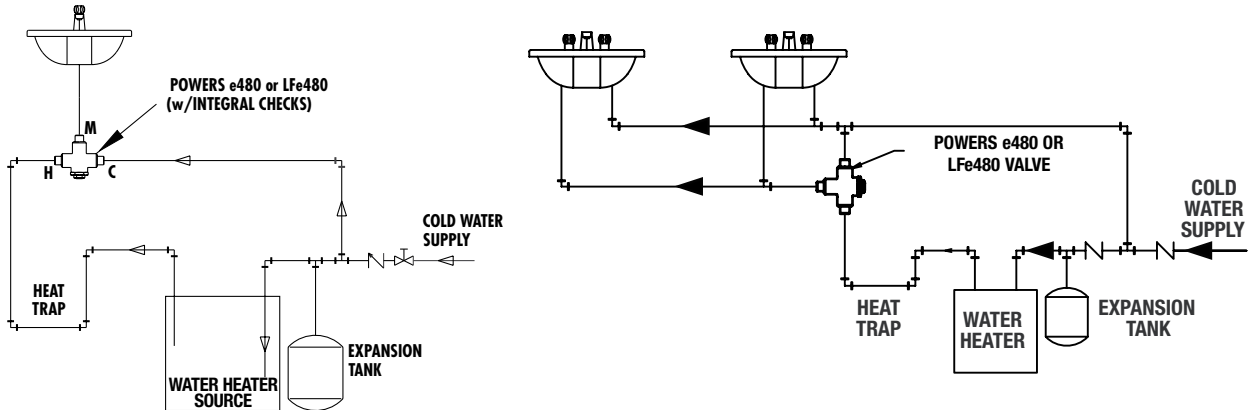

Ordering Code

- 1/2" NPT Rough Bronze Finish
- 1/2" NPT Chrome Plated Finish
- 3/8" Compression Rough Bronze Finish
- 3/8" Compression Chrome Plated Finish
- 3/8" Quick-Connect Rough Bronze Finish
- 3/8" Quick-Connect Chrome Plated Finish

e480 -	Order Code
00	
01	
10	
11	
50	
51	

Typical Specification

Lavatory tempering valve shall be ASSE 1070 listed and CSA certified. All internal components shall be from corrosion resistant material. The valve must control each performance standard down to 0.5 gpm (1.9 lpm).

Capacity of the valve must be 4 gpm (15 lpm) @ 45psi differential and be constructed of solid brass. Control temperature must be adjustable between 80 – 120°F (32 – 43°C) with a locking nut to prevent unauthorized or accidental adjustment. The valve shall contain integral checks to prevent cross flow and inlet screens to filter debris. The valve shall be a Powers Series e480.

POWERS™

A WATTS Brand

USA: Tel: (800) 669-5430 • Fax: (847) 229-0526 • PowersControls.com
 Canada: Tel: (905) 332-4090 • Fax: (905) 332-7068 • PowersControls.ca
 Latin America: Tel: (52) 81-1001-8600 • PowersControls.com