

For Non-Health Hazard Applications

Job Name _____ Contractor _____
 Job Location _____ Approval _____
 Engineer _____ Contractor's P.O. No. _____
 Approval _____ Representative _____

Showerhead

Part No. 141-376, 141-377

Specifications

Description	Ball Joint Showerhead with adjustable shower pattern
Material	Brass
Finish	Polished Chrome
Agency/Spec Approval	ANSI A112.18.1M CSA B125
Maximum Flow	2.5 gpm @ 80 psi (9.5 l/min @ 550 kPa)
Shipping Weight	141-376 — 1.3 lb (0.6 kg) 141-377 — 0.9 lb (0.4 kg)

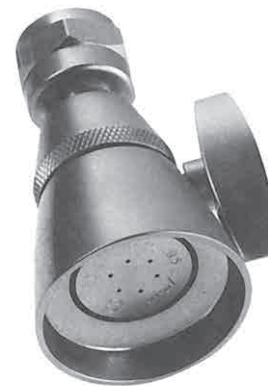

Dimensions

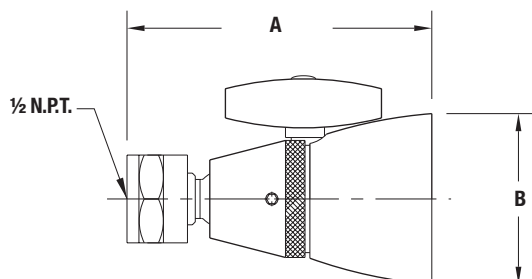

Indicate Desired Fitting

3	Part Number	Type	A	B
<input type="checkbox"/>	141-376	M	3-5/8" (92mm)	2-1/4" (57mm)
<input type="checkbox"/>	141-377	K	3-1/8" (79mm)	1-3/4" (44mm)

Powers product specifications in U.S. customary units and metric are approximate and are provided for reference only. For precise measurements, please contact Powers Technical Service. Powers reserves the right to change or modify product design, construction, specifications, or materials without prior notice and without incurring any obligation to make such changes and modifications on Powers products previously or subsequently sold.

USA: Tel: (800) 669-5430 • Fax: (847) 229-0526 • PowersControls.com
Canada: Tel: (905) 332-4090 • Fax: (905) 332-7068 • PowersControls.ca
Latin America: Tel: (52) 81-1001-8600 • PowersControls.com

POWERS™
A WATTS Brand