

# Models: 863M, 864M, 865, 866

## Cast Carbon and Alloy Steel Screwed & Socket Weld End Y Strainers Sizes: 1/2" - 2" (15 - 50mm)

Pressure/Temperature - Non-Shock		
Model	Material	Rating
863M, 864M	Carbon Steel	3705psi @-20°F to 100°F 255.45 bar @ 37.78°C 1595psi @ 850°F 109.97 bar @ 454.44°C
863M, 864M	Chrome- Moly	3750psi @-20°F to 100°F 258.55 bar @ 37.78°C 1500psi @ 975°F 103.42 bar @ 523.89°C
865, 866	Carbon Steel	6170psi @-20°F to 100°F 425.41 bar @ 37.78°C 2655psi @ 850°F 183.06 bar @ 454.44°C
865, 866	Chrome- Moly	6250psi @-20°F to 100°F 430.92 bar @ 37.78°C 2500psi @ 975°F 172.37 bar @ 523.89°C

**863M Screwed            Class 1500**  
**864M Socket            Class 1500**

**865 Screwed            Class 2500**  
**866 Socket            Class 2500**



Models 863M, 864M



Models 865, 866

### Typical Service

- Used extensively to strain foreign matter from pipelines and provide economical protection for costly pumps, meters, valves, and other similar mechanical equipment.
- These are especially critical as weld debris is often present in the pipeline.
- Well suited for long service in high pressure and temperature applications.

### Features

- Machined seats in both body and cap align and lock the screen in place to stop sediment bypass.
- Machined seats facilitate alignment and accurate reseating after servicing.

### Construction

- Most are furnished with a removable bolted cap for easy maintenance.
  - NOTE: 1" and smaller 863M and 864M have screwed cap.
- Heavy duty, rugged bodies with extra heavy bore.

### Self-Cleaning

- Self-cleaning is accomplished by opening the plug or valve connected to the blowoff outlet

### Blowoff Outlets

- Covers are furnished blind. Socket weld blowoff connection are available, consult factory.
- 1" and smaller 863M and 864M are furnished with NPT tapped blowoff.
- Sizes of tapping specified on next page
- Not normally furnished with plug. Plug available, specify with order.

### Capacity

- Generously proportioned bodies
- Open Area Ratio much greater than pipe size, ensuring low pressure drop.
- Minimum of 4 to 1 Open Area Ratio.

### Screens

MODEL	SIZES	STANDARD (WATER)		STEAM RECOMMENDATION	
		MATERIAL	OPENING	MATERIAL	OPENING
All	1/2" - 2"	304SS	.062 perf	304SS	.045 perf

Job Name \_\_\_\_\_  
 Job Location \_\_\_\_\_  
 Engineer \_\_\_\_\_  
 Approval \_\_\_\_\_

Contractor \_\_\_\_\_  
 Approval \_\_\_\_\_  
 Contractor's P.O. No. \_\_\_\_\_  
 Representative \_\_\_\_\_

## Material

	863M, 864M, 865, 866
Body	Carbon Steel, ASTM A216 Grade WCB
Cap	Carbon Steel, ASTM A216 Grade WCB
Gasket	Spiral Wound SS, Graphite Filled

### ALSO AVAILABLE:

Body/Cap: Carbon-Moly ASTM A217 Gr. W1  
 Chrome-Moly ASTM A217 Gr. WC6  
 Chrome-Moly ASTM A217 Gr. WC9

## Pressure Drop

• See Pressure Drop Charts in Technical Data Section in the Mueller Steam Specialty Engineering binder.

## Dimensions and Weights

SIZE		DIMENSIONS							WEIGHT						
		A		B		C (NPT)		D		E		F Screen Removal			
in.	mm	in.	mm	in.	mm	in.	mm	in.	mm	in.	mm	lbs.	kgs.		
<b>863M</b>															
1/2	15	3 <sup>29</sup> / <sub>32</sub>	99.2	3	76	1/4	6	—	—	—	—	3 <sup>3</sup> / <sub>4</sub>	95	2.25	1.02
3/4	20	4 <sup>1</sup> / <sub>4</sub>	108	3 <sup>5</sup> / <sub>8</sub>	92	3/8	10	—	—	—	—	4 <sup>3</sup> / <sub>8</sub>	111	3.75	1.7
1	25	5	127	4 <sup>1</sup> / <sub>8</sub>	105	1/2	14	—	—	—	—	5 <sup>1</sup> / <sub>4</sub>	133	6.5	2.9
1 1/4	32	8 <sup>3</sup> / <sub>8</sub>	213	7	178	—	—	—	—	—	—	7 <sup>3</sup> / <sub>4</sub>	197	22	10
1 1/2	40	8 <sup>3</sup> / <sub>8</sub>	213	7	178	—	—	—	—	—	—	7 <sup>3</sup> / <sub>4</sub>	197	22	10
2	50	9 <sup>5</sup> / <sub>16</sub>	237	7 <sup>3</sup> / <sub>8</sub>	187	—	—	—	—	—	—	9	229	30	13
<b>864M</b>															
1/2	15	3 <sup>29</sup> / <sub>32</sub>	99.2	3	76	1/4	6	3/8	10	7/8	21.7	3 <sup>3</sup> / <sub>4</sub>	95	2.25	1.02
3/4	20	4 <sup>1</sup> / <sub>4</sub>	108	3 <sup>5</sup> / <sub>8</sub>	92	3/8	10	1/2	13	1 <sup>1</sup> / <sub>16</sub>	27	4 <sup>3</sup> / <sub>8</sub>	111	3.75	1.7
1	25	5	127	4 <sup>1</sup> / <sub>8</sub>	105	1/2	14	1/2	13	1 <sup>1</sup> / <sub>16</sub>	33.8	5 <sup>1</sup> / <sub>4</sub>	133	6.5	2.9
1 1/4	32	8 <sup>3</sup> / <sub>8</sub>	213	7	178	CF	CF	1/2	13	1 <sup>1</sup> / <sub>16</sub>	42.5	7 <sup>3</sup> / <sub>4</sub>	197	22	10
1 1/2	40	8 <sup>3</sup> / <sub>8</sub>	213	7	178	CF	CF	1/2	13	1 <sup>15</sup> / <sub>16</sub>	48.6	7 <sup>3</sup> / <sub>4</sub>	197	22	10
2	50	9 <sup>5</sup> / <sub>16</sub>	237	7 <sup>3</sup> / <sub>8</sub>	187	CF	CF	5/8	16	2 <sup>3</sup> / <sub>8</sub>	61.1	9	229	30	13
<b>865</b>															
1/2	15	12 <sup>5</sup> / <sub>8</sub>	321	7 <sup>11</sup> / <sub>16</sub>	195	—	—	—	—	—	—	10 <sup>1</sup> / <sub>2</sub>	267	9	4
3/4	20	12 <sup>5</sup> / <sub>8</sub>	321	7 <sup>11</sup> / <sub>16</sub>	195	—	—	—	—	—	—	10 <sup>1</sup> / <sub>2</sub>	267	12	5.4
1	25	12 <sup>5</sup> / <sub>8</sub>	321	7 <sup>11</sup> / <sub>16</sub>	195	—	—	—	—	—	—	10 <sup>1</sup> / <sub>2</sub>	267	40	18
1 1/4	32	16 <sup>7</sup> / <sub>8</sub>	429	10 <sup>1</sup> / <sub>2</sub>	267	—	—	—	—	—	—	14 <sup>1</sup> / <sub>2</sub>	368	75	34
1 1/2	40	16 <sup>7</sup> / <sub>8</sub>	429	10 <sup>1</sup> / <sub>2</sub>	267	—	—	—	—	—	—	14 <sup>1</sup> / <sub>2</sub>	368	75	34
2	50	17	432	12 <sup>1</sup> / <sub>2</sub>	318	—	—	—	—	—	—	16 <sup>3</sup> / <sub>4</sub>	425	200	90
<b>866</b>															
1/2	15	12 <sup>5</sup> / <sub>8</sub>	321	7 <sup>11</sup> / <sub>16</sub>	195	—	—	3/8	10	7/8	21.7	10 <sup>1</sup> / <sub>2</sub>	267	9	4
3/4	20	12 <sup>5</sup> / <sub>8</sub>	321	7 <sup>11</sup> / <sub>16</sub>	195	—	—	1/2	13	1 <sup>1</sup> / <sub>16</sub>	27	10 <sup>1</sup> / <sub>2</sub>	267	12	5.4
1	25	12 <sup>5</sup> / <sub>8</sub>	321	7 <sup>11</sup> / <sub>16</sub>	195	—	—	1/2	13	1 <sup>1</sup> / <sub>16</sub>	33.8	10 <sup>1</sup> / <sub>2</sub>	267	40	18
1 1/4	32	16 <sup>7</sup> / <sub>8</sub>	429	10 <sup>1</sup> / <sub>2</sub>	267	—	—	1/2	13	1 <sup>1</sup> / <sub>16</sub>	42.5	14 <sup>1</sup> / <sub>2</sub>	368	75	34
1 1/2	40	16 <sup>7</sup> / <sub>8</sub>	429	10 <sup>1</sup> / <sub>2</sub>	267	—	—	1/2	13	1 <sup>15</sup> / <sub>16</sub>	48.6	14 <sup>1</sup> / <sub>2</sub>	368	75	34
2	50	17	432	12 <sup>1</sup> / <sub>2</sub>	318	—	—	5/8	16	2 <sup>3</sup> / <sub>8</sub>	61.1	16 <sup>3</sup> / <sub>4</sub>	425	200	90

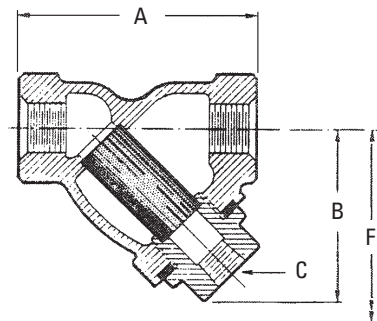

Model 863M, 864M

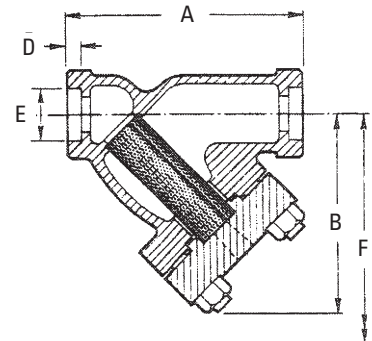

Model 865, 866

Apply For Certified Drawings.

Mueller Steam Specialty product specifications in U.S. customary units and metric are approximate and are provided for reference only. For precise measurements, please contact Mueller Steam Specialty Technical Service. Mueller Steam Specialty reserves the right to change or modify product design, construction, specifications, or materials without prior notice and without incurring any obligation to make such changes and modifications on Mueller Steam Specialty products previously or subsequently sold.



A Watts Water Technologies Company

USA: St. Pauls, NC • Tel. 1-800-334-6259 • Fax 1-800-421-6772 • www.muellersteam.com

ES-MS-863M\_4M\_65\_66 1020



© 2010 Mueller Steam Specialty