

**For Residential and Commercial Applications**

Job Name \_\_\_\_\_

Contractor \_\_\_\_\_

Job Location \_\_\_\_\_

Approval \_\_\_\_\_

Engineer \_\_\_\_\_

Contractor's P.O. No. \_\_\_\_\_

Approval \_\_\_\_\_

Representative \_\_\_\_\_

**LEAD FREE\***

**Series LF3005A  
Dielectric Unions**

**Sizes: 1/2" – 3/4"**

Series LF3005 dielectric unions feature a male iron pipe thread to solder connection. These unions are designed to be installed between pipe made from dissimilar metals to prevent accelerated corrosion and deterioration in the piping system due to galvanic and stray current. Designed and manufactured to the highest quality standards. Gasket rated to 210°F (99°) at 250psi (17.2 bar). The LF3005A features Lead Free\* construction to comply with Lead Free\* installation requirements.

**Features**

- Male iron pipe thread to solder connection
- Designed and manufactured to the highest quality standards
- Individually factory certified to withstand a minimum of 600 volts on a dry line with no flashover
- Rated to 180°F (82°C) at 250psi (17.2 bar)

**Specifications**

The dielectric union shall be constructed using Lead Free\* materials. Lead Free\* dielectric unions shall comply with state codes and standards, where applicable, requiring reduced lead content. The dielectric union shall be a Watts Series LF3005A.

**Materials – Dimensions – Weights**

SIZE	MATERIALS					DIMENSIONS				WEIGHT	
	TAIL PIECE	ADAPTER †	NUT †	INSULATOR	GASKET	A		B		oz.	gm
<i>in.</i>						<i>in.</i>	<i>mm</i>	<i>in.</i>	<i>mm</i>		
1/2	Lead Free Brass	Steel	Steel	Polysulfone	Buna-N	1 1/2	38	2 5/8	67	7.5	213
3/4	Lead Free Brass	Steel	Steel	Polysulfone	Buna-N	1 5/8	41	3	76	9	255

† Steel adapter and nut are zinc plated

LF3005A



**Standards**

Meet federal specifications for tensile strength and thread end connections.

**Pressure – Temperature**

Maximum Pressure: 250psi (17.2 bar)

Maximum Temperature: 180°F (82°C)

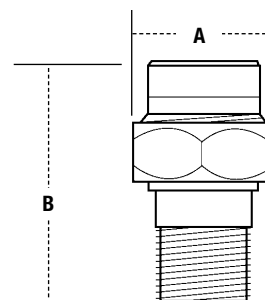

**NOTICE**

The information contained herein is not intended to replace the full product installation and safety information available or the experience of a trained product installer. You are required to thoroughly read all installation instructions and product safety information before beginning the installation of this product.

**NOTICE**

Inquire with governing authorities for local installation requirements

**\*The wetted surface of this product contacted by consumable water contains less than 0.25% of lead by weight.**

Watts product specifications in U.S. customary units and metric are approximate and are provided for reference only. For precise measurements, please contact Watts Technical Service. Watts reserves the right to change or modify product design, construction, specifications, or materials without prior notice and without incurring any obligation to make such changes and modifications on Watts products previously or subsequently sold.



**USA:** T: (978) 689-6066 • F: (978) 975-8350 • Watts.com

**Canada:** T: (905) 332-4090 • F: (905) 332-7068 • Watts.ca

**Latin America:** T: (52) 81-1001-8600 • Watts.com