

HydroGuard T/P®



Series e480 Lavatory Combination
Tempering Valves for Low Flow Control

description

HydroGuard T/P Series e480 Under-the-Counter Combination Tempering Valves are designed for lavatory applications where the temperature of hot water must be controlled for safe, economic use. An advanced thermal actuator quickly senses and compensates for outlet temperature fluctuations induced by water temperature and pressure changes in the supply line.

Rugged construction features solid brass body and corrosion-resistant, internal components ensuring years of dependable, trouble-free service. Temperature adjustment stem is simple to adjust and has a locking nut to prevent tampering. The HydroGuard T/P Series e480 meets the most stringent performance criteria for temperature and pressure, defined by ASSE 1016 (Type T/P) and CSA B125.



features and benefits

Powers' latest under-the-counter combination valves provide safe, tempered water delivery to lavatory sinks, insuring user safety and minimizing owner liability.

- Temperature control to ASSE 1016, type T/P down to 0.5 gpm.
- Advanced thermal actuator improves performance.
- Adjustable temperature selection with lock nut to prevent tampering.
- Solid brass construction enhances durability.
- Corrosion resistant internal components for extended life.
- Integral checks with screens prevents crossflow.
- Factory set at 105°F (40.6°C).

The e480 T/P series allows facilities to distribute water at higher temperatures, minimizing the potential occurrence of Legionella and other known bacteria which can be present at temperatures below 122°F (50°C). Ideal for low flow faucets (0.5 gpm) in:

- schools
- public restrooms
- hotels/motels
- sports facilities
- office buildings
- healthcare facilities
- apartments/condominiums
- correctional facilities

an inside look at quality

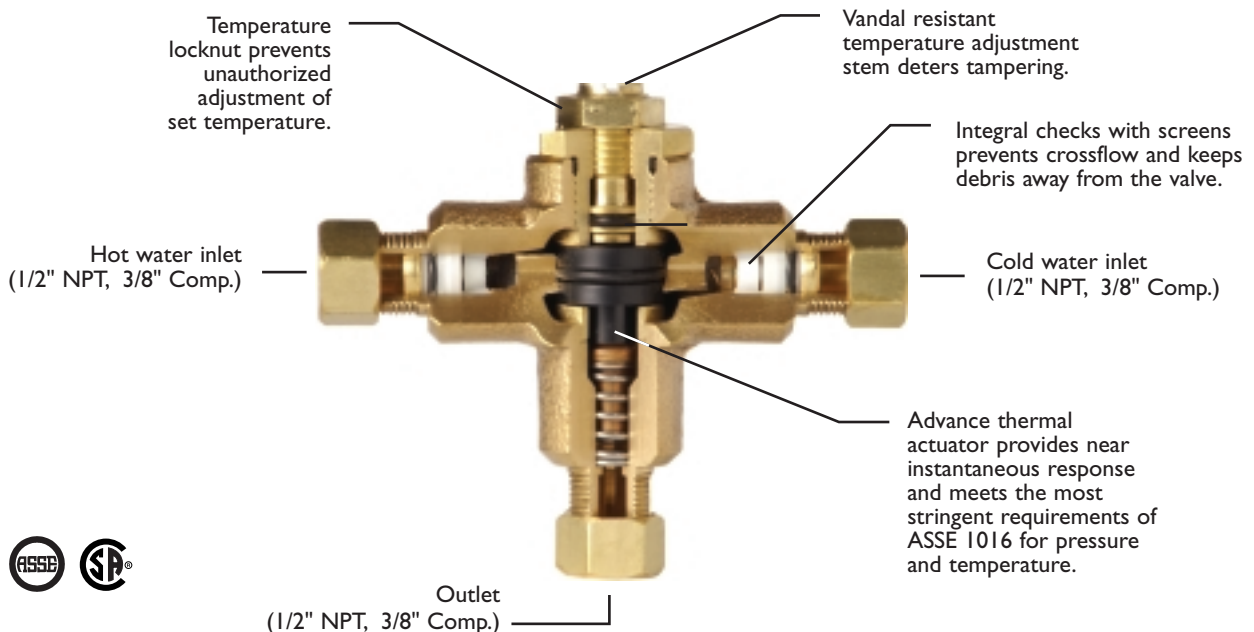

dimensions

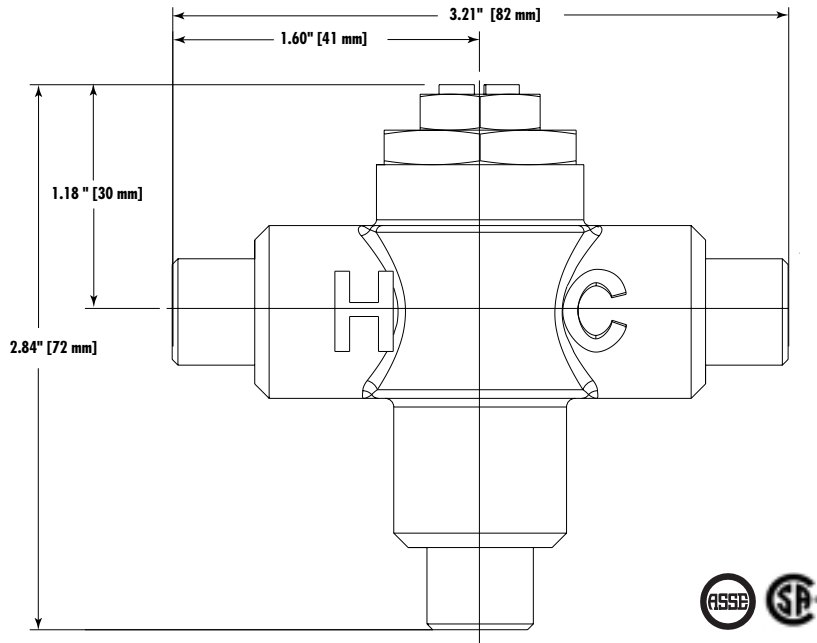

pip ing diagrams

SINGLE LAVATORY

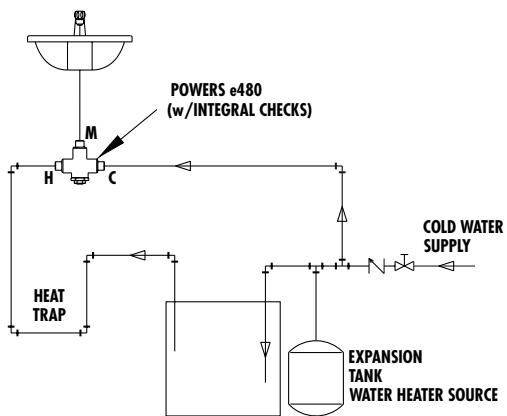

MULTIPLE LAVATORY

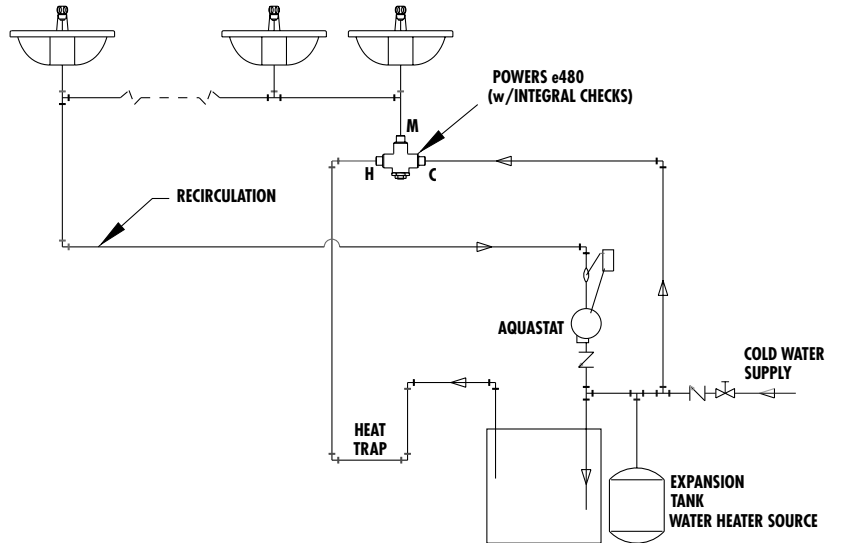

product specifications

	e480-00	e480-01	e480-10	e480-11
Connections:	1/2" NPT	1/2" NPT	3/8" Compression	3/8" Compression
Finish:	Rough Bronze	Rough Chrome	Rough Bronze	Rough Chrome
Capacity @ 45psi Δ	4 gpm (15 lpm)			
Approach Temperature:	5°F (2.8°C) above set point			
Max. Operating Pressure:	125 psi (862 kPa)			
Max. Static Pressure:	125 psi (862 kPa)			
Max. Hot Water Temp:	212°F (100°C)			
Temp Adjustment:	ASSE Type T/P: 95-110°F (35-48°C) ASSE Type T: 80-120°F (27-49°C)			
Minimum Flow:	0.5 gpm (2.2 lpm) to ASSE 1016			
Checks:	Integral with screens			
Construction:	Cast Brass Body			
Approval:	CSA B125 Certified			
Listing:	ASSE 1016 Type T/P			
Shipping Weight:	1 lb. (0.45 kg)			

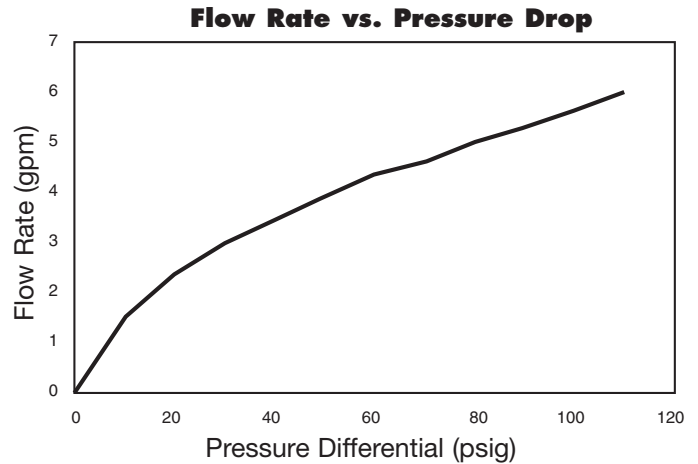

ordering code

Order Code	Description
<input type="checkbox"/> e480-00	1/2" NPT Rough Bronze Finish
<input type="checkbox"/> e480-01	1/2" NPT Rough Chrome Finish
<input type="checkbox"/> e480-10	3/8" Compression Rough Bronze Finish
<input type="checkbox"/> e480-11	3/8" Compression Rough Chrome Finish

typical specification

Combination tempering valve shall be ASSE 1016 Type T/P listed and CSA B125 certified. All internal components shall be from corrosion resistant material. The valve must control each performance standard down to 0.5 gpm (2.2 lpm).

Capacity of the valve must be 4 gpm (15 lpm) @ 45psig differential, and be constructed of solid brass. Control temperature must be adjustable between 80 and 120°F (32-43°C), with a locking nut to prevent unauthorized or accidental adjustment. The valve shall contain integral checks to prevent crossflow and inlet screens to filter debris. The valve shall be a Powers Model e480 series.

ENGINEERING APPROVAL

Project: _____

Contractor: _____

Architect/Engineer: _____