

IS-P-LM495 Installation Instructions • Instrucciones de instalación • Instructions d'installation

Series LFLM495

Hydroguard®

Thermostatic Tempering Valves

Válvulas termostáticas de mezclado

Vannes thermostatiques

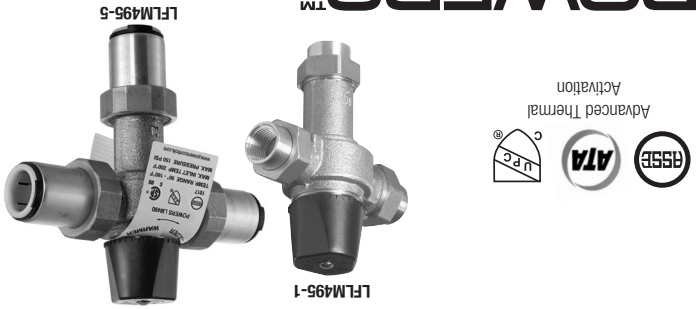

USA: T: (800) 669-5430 • F: (847) 229-0526 • PowersControls.com
 Canada: T: (905) 332-4090 • F: (905) 332-7068 • PowersControls.com
 Latin America: T: (52) 81-1001-8600 • F: (52) 81-8000-7091 • PowersControls.com
 EDP# 6511208

A WATTS Brand POWERS™

The Seller warrants that the equipment manufactured by it and covered by this order or contract is free from defects in material and workmanship and, without charge, equipment found to be defective in material or workmanship will be repaired, or at Seller's option replaced F.O.B. original point of shipment, if written notice of failure is received by Seller within one (1) year after date of shipment (unless specifically noted elsewhere), provided said equipment has been properly installed, operated in accordance with the Seller's instructions, and provided such defects are not due to abuse or decomposition by chemical or galvanic action. THIS EXPRESS WARRANTY IS IN LIEU OF AND EXCLUDES ALL OTHER WARRANTIES, GUARANTEES, OR REPRESENTATIONS, EXPRESS OR IMPLIED. THERE ARE NO IMPLIED WARRANTIES OF MERCHANTABILITY OR FITNESS FOR A PARTICULAR PURPOSE. The Seller assumes no responsibility for repairs made on the Seller's equipment unless done by the Seller's authorized personnel, or by written authority from the Seller. The Seller makes no guarantee with respect to material not manufactured by it.

Warranty

WARNING: This product contains chemicals known to the State of California to cause cancer and birth defects or other reproductive harm.
 For more information: Watts.com/prop65

Estados Unidos: T: (800) 669-5430 • F: (847) 229-0526 • PowersControls.com
 Canada: T: (905) 332-4090 • F: (905) 332-7068 • PowersControls.com
 Latinoamérica: T: (52) 81-1001-8600 • F: (52) 81-8000-7091 • PowersControls.com
 EDP# 6511208

A WATTS Brand POWERS™

El Vendedor garantiza que los equipos fabricados por él y cubiertos por esta orden o contrato está libre de defectos en los materiales y mano de obra y que los equipos con materiales o mano de obra defectuosos serán reparados sin cargo o, a opción del Vendedor, reemplazados F.O.B. en el punto original de envío, si el Vendedor recibe una notificación por escrito de falla en el lapso de un (1) año después de la fecha de envío (a menos que se especifique en otra parte), siempre y cuando dichos equipos hayan sido correctamente instalados y utilizados de conformidad con las instrucciones del Vendedor, y siempre que dichos defectos no se deban a maltrato o descomposición o corrosión química o galvánica. ESTA GARANTÍA EXPRESA REEMPLAZA Y EXCLUYE CUALQUIER OTRA GARANTÍA, GARANTÍA GARANTÍA O PROMESA, EXPRESAS O IMPLÍCITAS. NO EXISTEN GARANTÍAS IMPLÍCITAS DE COMERCIALIZACIÓN O DE IDONEIDAD PARA UN PROPÓSITO EN PARTICULAR. El Vendedor no asume ninguna responsabilidad por las reparaciones hechas a los equipos del Vendedor salvo que se realicen por personal autorizado por el Vendedor o con autorización escrita del Vendedor. El Vendedor no otorga ninguna garantía con respecto a los materiales no fabricados por él.

Garantía

ADVERTENCIA: Este producto contiene sustancias químicas que en el Estado de California se conocen como causantes de cáncer y malformaciones u otros daños reproductivos.
 Para más información: Watts.com/prop65

É.-U. : T: (800) 669-5430 • F: (847) 229-0526 • PowersControls.com
 Canada : T: (905) 332-4090 • F: (905) 332-7068 • PowersControls.com
 Amérique latine : T: (52) 81-1001-8600 • F: (52) 81-8000-7091 • PowersControls.com
 EDP# 6511208

A WATTS Brand POWERS™

Le vendeur garantit que l'équipement fabriqué par lui et couvert en vertu de cette commande ou de ce contrat est exempt de vices de matériau et de fabrication et, dans l'éventualité ou de tels vices de matériau ou de fabrication se manifestent, il sera réparé sans frais ou, à la discrétion du vendeur, remplacé franco teraent, à bord (FAB) de son point d'expédition d'origine (sauf si spécifié ailleurs), pourvu que l'équipement ait été installé correctement et utilisé conformément aux instructions du vendeur et, pourvu que de tels vices ne soient pas le résultat d'une utilisation abusive ou d'une décomposition ou d'une réaction chimique ou galvanique. LA PRÉSENTE GARANTIE EST EXPRESSE, REMPLACE ET EXCLUT TOUTE AUTRE GARANTIE OU REPRÉSENTATION EXPRESSE OU IMPLICITE. IL N'EXISTE AUCUNE GARANTIE TACITE DE QUALITÉ MARCHANDE OU D'ADAPTATION À UN BUT PARTICULIER. Le vendeur n'assume aucune responsabilité pour des réparations effectuées sur son équipement à moins qu'elles aient été effectuées par du personnel autorisé par lui ou par une autorisation écrite de lui. Le vendeur n'offre aucune garantie pour les matériaux non fabriqués par lui.

Garantie

AVERTISSEMENT : Ce produit contient des produits chimiques reconnus par l'Etat de Californie comme étant cancérogènes et pouvant provoquer des anomalies congénitales ou affecter la capacité de reproduction.
 Pour plus d'informations : Watts.com/prop65

WARNING
 Read this Manual BEFORE using this equipment. Failure to read and follow all safety and use information can result in death, serious personal injury, property damage, or damage to the equipment. Keep this Manual for future reference.

WARNING
 Local building or plumbing codes may require modifications to the information provided. You are required to consult the local building and plumbing codes prior to installation. If the information provided here is not consistent with local building or plumbing codes, the local codes should be followed. This product must be installed by a licensed contractor in accordance with local codes and ordinances.

WARNING
FAILURE TO COMPLY WITH PROPER INSTALLATION AND MAINTENANCE INSTRUCTIONS COULD CONTRIBUTE TO THE VALVE FAILURE, RESULTING IN INJURY AND/OR DEATH.
TO ENSURE THE ACCURATE AND RELIABLE OPERATION OF THIS PRODUCT, IT IS ESSENTIAL TO:

- Properly design the system to minimize pressure and temperature variations.
- This valve is not factory preset and can be adjusted to deliver scalding temperatures. **Check outlet temperature to ensure it does not exceed 105°F (41°C).** Make sure temperature limit stop is properly re-set to maximum 105°F (41°C) following valve maintenance or repair. Tampering with limit stop in any way may result in scalding temperature causing serious bodily harm and/or death.

WARNING
Need for Periodic Inspection and Yearly Maintenance: Periodic inspection and yearly maintenance by a licensed contractor is required. Corrosive water conditions, temperatures over 200°F, unauthorized adjustments or repair could render the valve ineffective for service intended. Regular checking and cleaning of the valve's internal components and check stops helps assure maximum life and proper product function. Frequency of cleaning and inspection depends upon local water conditions.

NOTICE
 Flush all pipes thoroughly before installation. Installation and field adjustment are the responsibility of the installer.

Installation Instructions

- Locate suitable place for the tempering valve. Valves should be accessible for service and adjustment, and be as close to the point of use as possible.
- Bleed pressure from the system.
- Route copper tubing or piping to fit valve dimensions.
- For valves with Quick-Connect tailpieces refer to "Quick-Connect Installation" instructions below.
- Remove tailpieces from the valve and make sure union nuts are over the tubing/piping before connecting to the tailpiece.

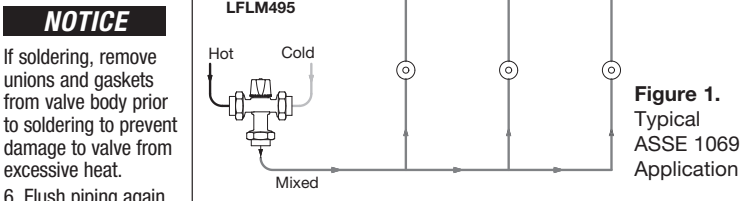

Figure 1. Typical ASSE 1069 Application

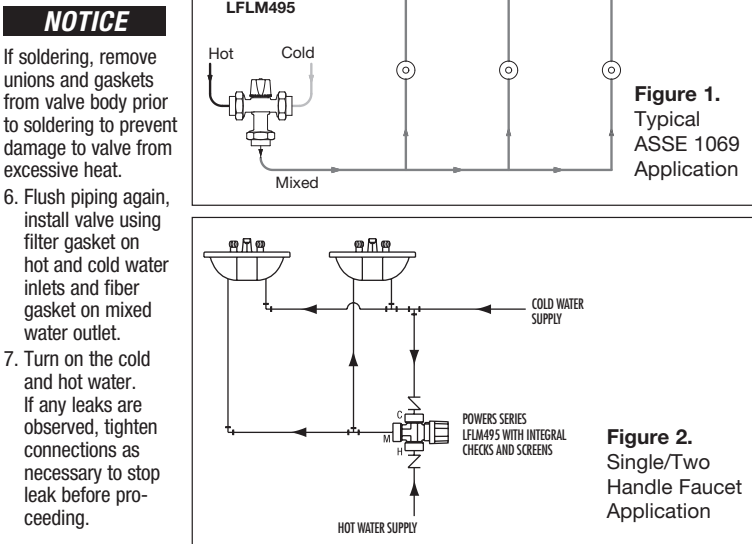
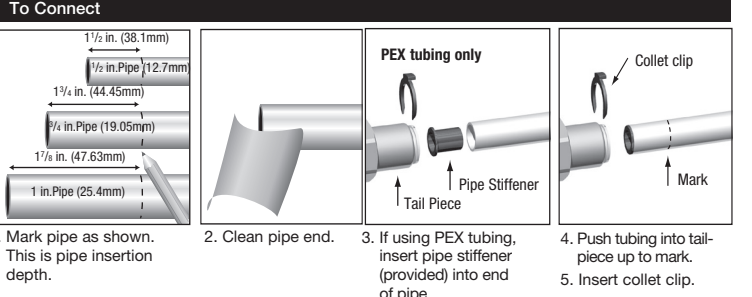

Figure 2. Single/Two Handle Faucet Application

NOTICE
 If soldering, remove unions and gaskets from valve body prior to soldering to prevent damage to valve from excessive heat.

- Turn on the cold and hot water. If any leaks are observed, tighten connections as necessary to stop leak before proceeding.

Quick-Connect Installation



To Disconnect

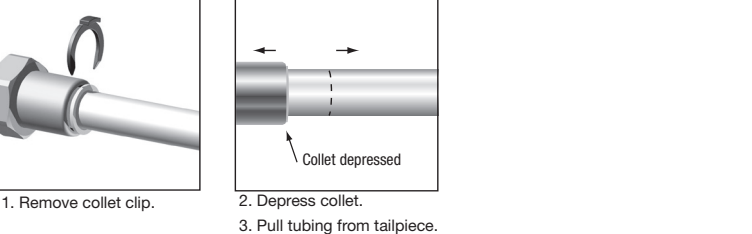

WARNING
 For valves with CPVC or PEX end connections, do not exceed the tubing manufacturers pressure and temperature ratings. Refer to the tubing manufacturers product specifications for that information.

Model	Part #	Description
LFLM495	495 100	Plunger/Motor Assembly

To Adjust Temperature (Figure 3)

- Let the water flow for at least two minutes to allow supply temperature to stabilize.
- Place a thermometer in the outlet water stream.
- Loosen handle screw with hex wrench.
- Handle must be lifted 1/4" to adjust temperature. Rotate handle clockwise to decrease temperature and counter-clockwise to increase the temperature.
- Lower handle and tighten screw.
- Check for outlet temperature.

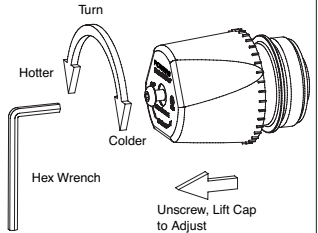

Figure 3.

NOTICE
 Pressure Differential between Hot & Cold Water Supplies must be less than 25%.

NOTICE
 It is recommended that shutoff valve(s) be installed on the inlet(s) to facilitate service of the LFLM495 valve.

Troubleshooting

- Fluctuating or erratic hot water temperature at fixture:** Unbalanced Pressure. Install balancing or throttling valve at the hot and cold water supplies and adjust accordingly for demand.
- Hot water backing up into cold water line:** Hot water pressure is higher than cold water pressure. Examine check valves for dirt & debris, clean as necessary.
- Cannot adjust water temperature to desired temperature:** Install balancing or throttling valve at the hot and cold water supplies and adjust accordingly for demand.
- High pressure drop through the tempering valve:** Valve undersized. Install larger thermostatic tempering valve.
- Insufficient hot water during peak demand:** Check flow requirement during peak demand period. Use larger thermostatic tempering valve.

